

A09351-7		
REV.	ECN NO.	DATE
A	CN8005	03-10-'08
B	CN10089	06-17-'11

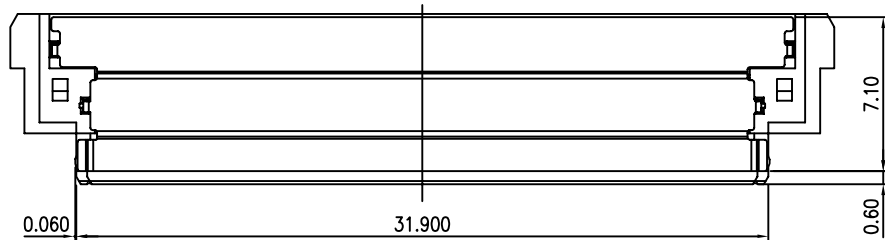
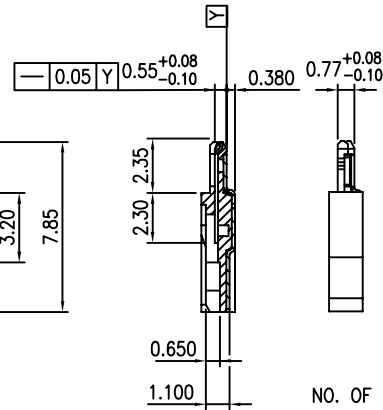
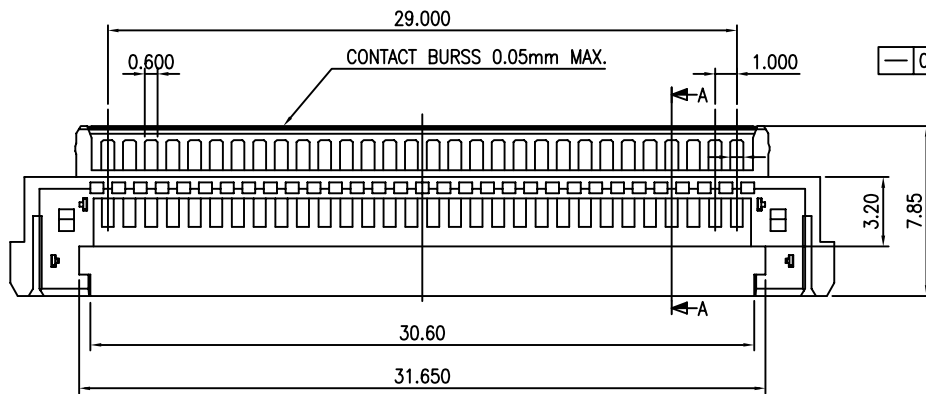
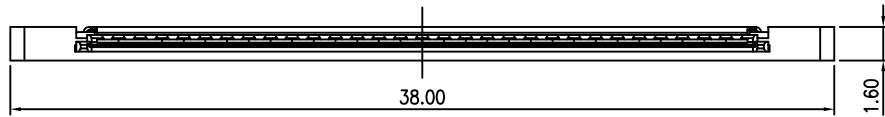

NOTES:

- UNLESS OTHERWISE SPECIFIED, ALL TOLERANCES FOLLOW DRAWING COMMON STANDARD.
- UNLESS OTHERWISE SPECIFIED, ALL RADIUSSES ARE 0.2 MM.
- MATERIAL :
 INSULATOR L.C.P, BLACK, UL94V-0
 CONTACT PHOSPHOR BRONZE, C5191R-H
 LOWER SHIELED PHOSPHOR BRONZE, C5191R-H
- PART NO. SYSTEM

0 9 3 E 3 0 - 0 0 0 2 X 0 - G 4 - N

NO. OF POSITIONS : _____
 30-POSITION

COLOR OPTION : _____
 00..... BLACK COLOR

TYPE OPTION : _____
 2..... TYPE 2

LOWER SHIELED PLATING : _____
 2..... PURE-TIN 60~150 μ" OVER NICKEL
 50~150 μ" UNDER-PLATING

4..... 0.127 μm [5 μ"]

CONTACT PLATING :
 G..... GOLD PLATED OVER ALL &
 OVER NICKEL 50~150 μ"
 UNDER PLATING.

LOGO :
 0..... NONE LOGO

PROJECTION 	TOLERANCE UNLESS OTHERWISE SPECIFIED		STARCONN 慶良電子股份有限公司 CHIEF LAND ELECTRONIC CO., LTD.
	LINEAR	ANGLE	
UNITS	.0 ± 0.35	X° REF ± 5'	TITLE
MM[INCH]	.00 ± 0.25	X' ± 2'	COAXIAL CABLE CONNECTOR 1.0mm PH
	.000 ± 0.15	X'X' ± 1'	, ASSEMBLY,TYPE 2 (INSERT MOLDING)
SCALE	DRAW	DESIGN	DWG NO.
4:1	Rob Yang	Rob Yang	093E30-XXX2XX-XX-N
SIZE	CHKD	APPD.	CAD NO.
A3	Fason Chou	Fason Chou	E09351-7
			REV.
			B
			SHEET
			7/7

5	A09354-2	
REV.	ECN NO.	DATE
A	CN6049	07-26-'06
B	CN10089	06-17-'11

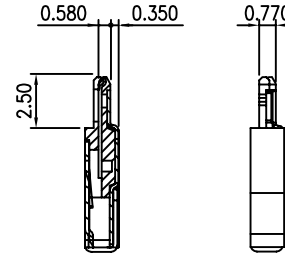
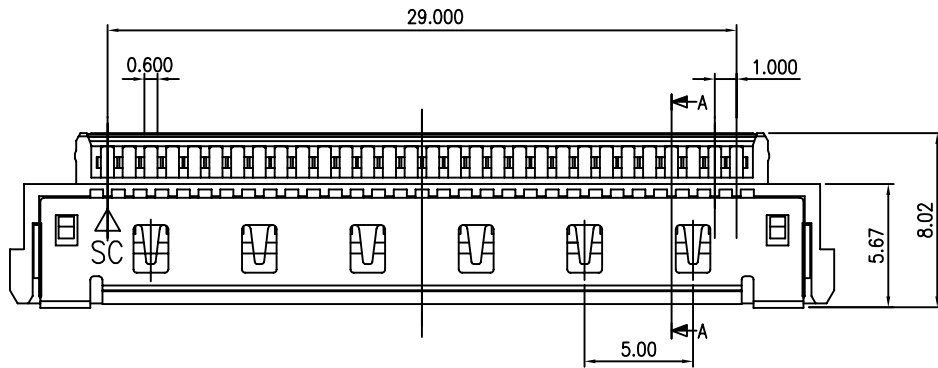
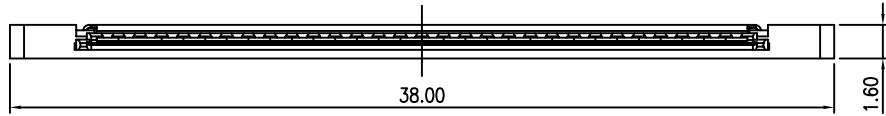

SEC. A-A

MATERIAL :

INSULATOR..... L.C.P, BLACK, UL94V-0

CONTACT..... PHOSPHOR BRONZE , C5191R-H

UPPER SHIELED.. PHOSPHOR BRONZE , C5191R-H

LOWER SHIELED.. PHOSPHOR BRONZE , C5191R-H

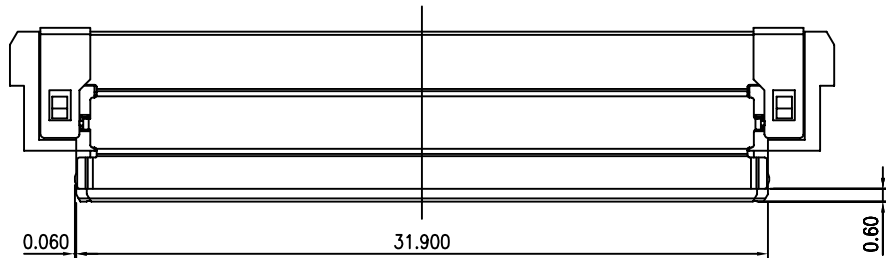
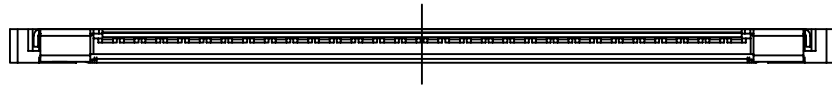

PROJECTION 	TOLERANCE UNLESS OTHERWISE SPECIFIED		STARCONN 慶良電子股份有限公司 CHIEF LAND ELECTRONIC CO., LTD.
	LINEAR	ANGLE	
UNITS	.0 ± 0.35	X° REF ± 5'	TITLE
MM[INCH]	.00 ± 0.25	X' ± 2"	COAXIAL CABLE CONNECTOR 1.0mm PH
	.000 ± 0.15	X'X' ± 1'	TYPE,ASSEMBLY,TYPE 3(INSET MOLDING)
SCALE	DRAW	Rob Yang 06-17-'11	DWG NO.
	DESIGN	Rob Yang 06-17-'11	093EXX-XXX3XX-N
SIZE	CHKD	Fason Chou 06-17-'11	CAD NO.
	APPD.	Fason Chou 06-17-'11	E09354-2
			REV.
			B
			SHEET
			2/2

S09336-4		
REV.	ECN NO.	DATE
A	CN8005	03-10-'08

NOTES:

- UNLESS OTHERWISE SPECIFIED, ALL TOLERANCES FOLLOW DRAWING COMMON STANDARD.
- UNLESS OTHERWISE SPECIFIED, ALL RADIUSSES ARE 0.2 MM.
- MATERIAL : PHOSPHOR BRONZE, JIS C5191R-H
THICKNESS=0.20±0.01mm.

4. PART NO. DESCRIPTION

S 0 9 3 3 6 - X 0 X X 0 0 - T 1

BLUGE OPTION :
0 WITHOUT BLUGE
1 WITH BLUGE

DIM.A OPTION :
0 0.35mm
1 0.70mm

LOGO OPTION :
0 NON-LOGO
A STARCONN(SC)

INDEX=0

PLATING :

T PURE-TIN 60μ"~150μ" OVER NICKEL
50μ" MIN. UNDER-PLATING

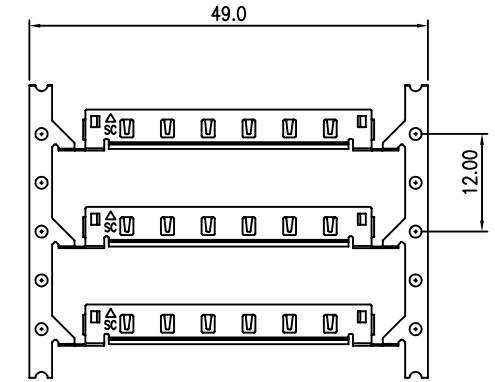
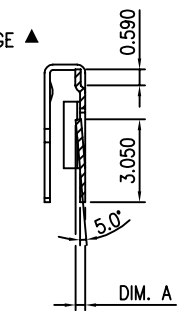
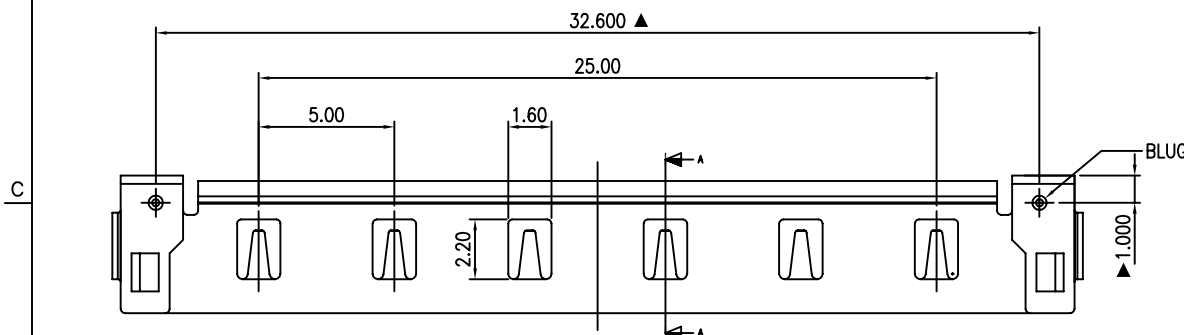
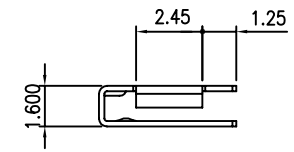
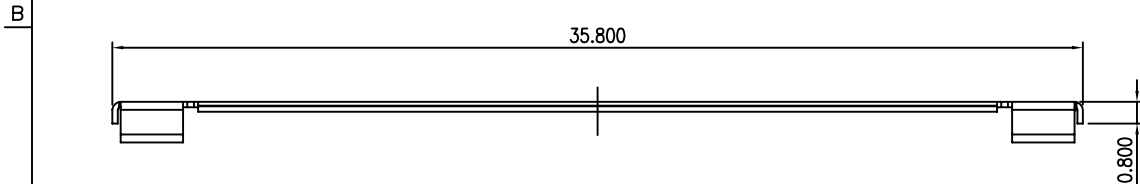
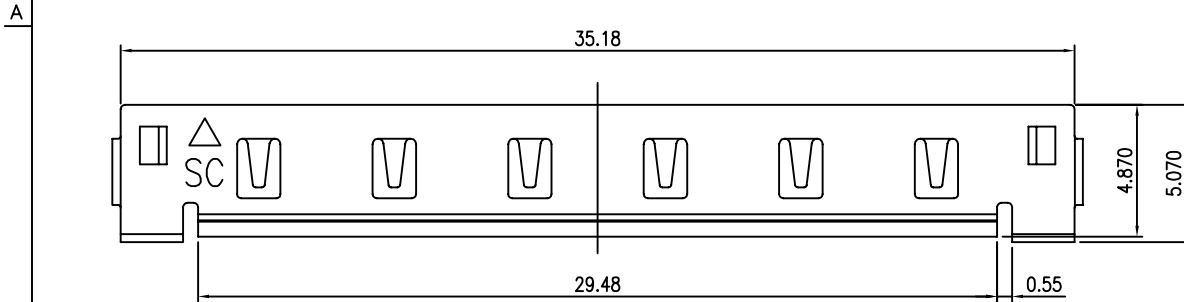

SCALE 1.5:1

SEC. A-A

APPLICATION PRODUCT		PROJECTION	TOLERANCE UNLESS OTHERWISE SPECIFIED		STARCONN 廣 茂 電 子 股 份 有 限 公 司 CHIEF LAND ELECTRONIC CO., LTD.
PRODUCT NO.	CAD NO.		LINEAR	ANGLE	
093D30-XXXXXX	A09330-1~4	UNITS	.0 ± 0.35	X' REF ± 5'	TITLE
093E30-XXXXXX	A09350-1~3	MM[INCH]	.00 ± 0.25	X' ± 2'	COAXIAL CABLE CONNECTOR 1.0mm PH
	A09351-1~2		.000 ± 0.15	X'X' ± 1'	TYPE,30-POS UPPER SHELL
		SCALE	DRAW	07-02-'10	DWG NO.
		5:1	DESIGN	07-02-'10	S09336-XXXXXX-XX
		SIZE	CHKD	07-02-'10	CAD NO.
		A3	APPD.	07-02-'10	E09336-2
					REV.
					1B
					SHEET
					2/2